

EXPLODED VIEW

Parts List

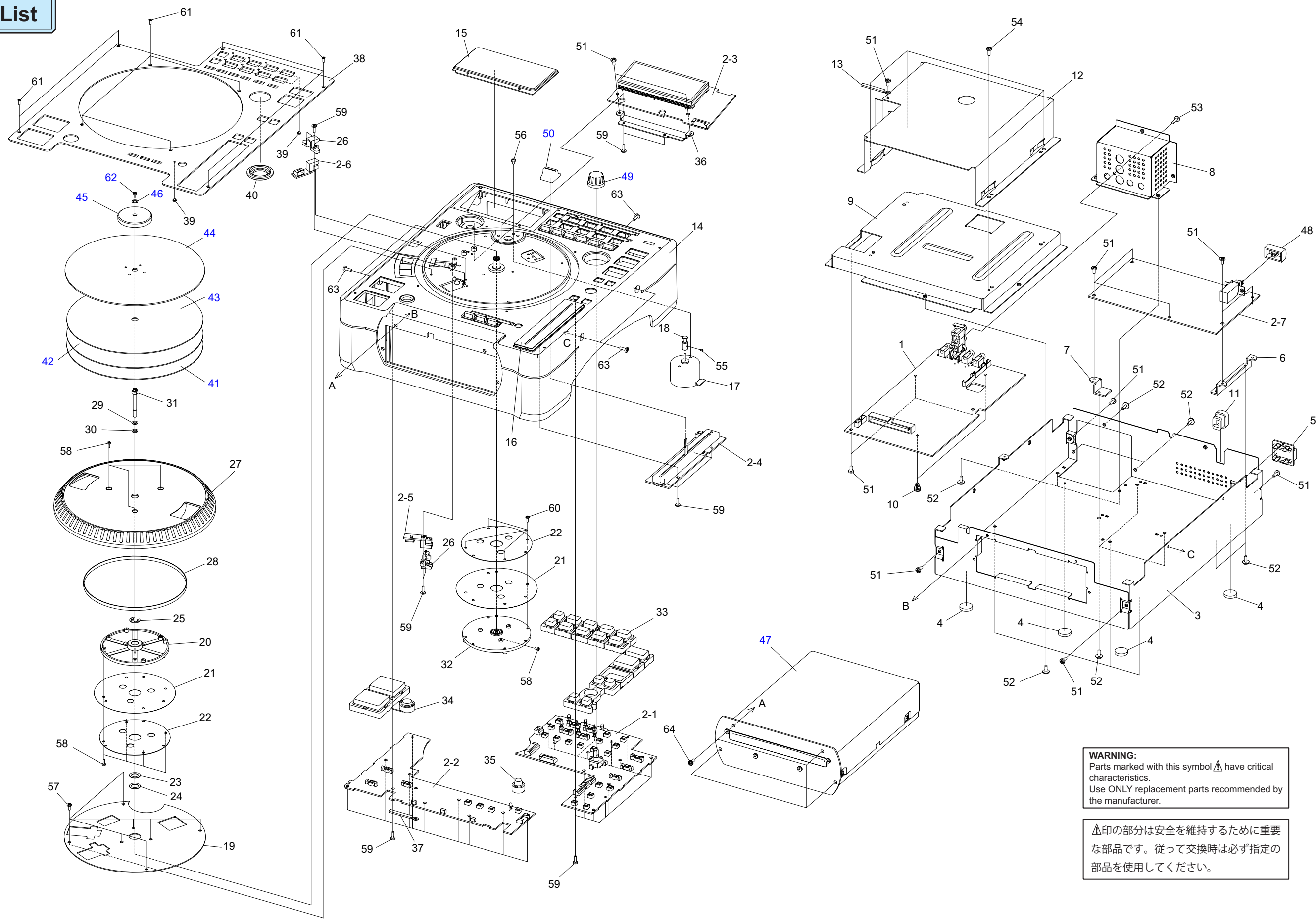

**WARNING:**  
 Parts marked with this symbol  $\triangle$  have critical characteristics.  
 Use ONLY replacement parts recommended by the manufacturer.

$\triangle$ 印の部分は安全を維持するために重要な部品です。従って交換時は必ず指定の部品を使用してください。

## PARTS LIST OF EXPLODED VIEW

\*本表に記載されている部品は、補修用部品のため製品に使用している部品とは一部、形状、寸法などが異なる場合があります。

**Note:** The symbols in the column "Remarks" indicate the following destinations.

E3: U.S.A. & Canada model

E2: Europe model

JP: Japan model

Ref.No.	Part No.	Part Name	Remarks	Q'ty	New
1	GU-3546	DSP PWB UNIT		1	*
2	GU-3547	PANEL PWB UNIT		1	*
2-1		PANEL UNIT			
2-2		PANEL2 UNIT			
2-3		FLT UNIT			
2-4		SLIDE VR UNIT			
2-5		DISC SENSOR UNIT			
2-6		TABLE SENSOR UNIT			
2-7		POWER UNIT			
3	411 2027 210	CHASSIS		1	
4	461 0706 127	FOOT SHEET		4	
5	146 2302 002	P.SW KNOB GUIDE		1	
6	412 4921 003	PWB BRACKET		1	
7	412 5003 001	PWB SUPPORT		3	
8	412 5050 009	JACK BRACKET		1	*
9	412 5005 009	MAIN BRACKET		1	
10	412 2814 031	CARD SPACER (L=4)		2	
11	445 0084 009	CORD BUSH	for E3	1	
11	445 0056 008	CORD BUSH	for E2,JP	1	
12	412 5006 008	MECHA COVER		1	
13	445 0048 003	CORD HOLDER (L76)		1	
14	146 2303 218	INNER COVER ASS'Y		1	*
15	146 2305 119	WINDOW		1	*
16	146 2325 005	FADER PLATE		1	*
17	217 0181 006	LOADING MOTOR		1	
18	422 0670 106	MOTOR PULLY		1	
19	441 1974 006	BASE PLATE		1	
20	421 0798 001	PLATTER HOLDER		1	
21	421 0799 107	SCALE DISK		2	
22	441 1975 005	DISK FIX PLATE		2	
23	475 1187 003	WASHER 13/8.2		1	
24	475 1161 058	WASHER 8.2/12		1	
25	476 1006 006	6 E RING ZNP		1	
26	443 1573 005	S.COVER (GP1A70R)		2	
27	421 0815 007	PLATTER		1	*
28	423 0079 108	BELT		1	
29	475 1187 016	WASHER 7/4.1		1	
30	475 1161 016	WASHER		1	
31	422 0669 308	DISC HOLDER SHAFT		1	
32	421 0801 105	WHEEL ASS'Y		1	
33	119 0124 109	R.KEY (FUNCTION)		1	*
34	119 0119 305	R.KEY (PLAY/PAUSE)		1	
35	119 0120 103	R.KEY (PITCH)		1	
36	412 5007 007	FL BRACKET		1	
37	445 8028 009	CORD HOLDER		1	
38	144 2843 109	TOP PANEL		1	*
39	143 1163 007	LENS		7	
40	146 2306 008	KNOB (MARU) LENS		1	
41	421 0810 002	ANTI-STATIC SHEET		1	
42	421 0809 000	SLIP SHEET		1	
43	421 0802 007	SLIP MAT		1	

	Ref.No.	Part No.	Part Name	Remarks	Q'ty	New
	44	421 0803 307	SLIP DISC		1	
	45	421 0820 005	STABILIZER (A)		1	*
	46	475 1187 029	WASHER 5/2.2		1	
	47	FG5 000	DRIVE UNIT		1	
	48	113 1689 001	P.SW KNOB		1	
	49	112 0902 016	KNOB (MARU)		1	*
	50	113 1951 014	FADER KNOB		1	*
	★ 71	204 6752 019	40P FLAT CABLE	CX401	1	
⚠	★ 72	203 6577 026	4P LC-VH CON.CORD	CX941	1	
	★ 73	206 2155 001	AC CORD W/CON.E3	for E3	1	
	★ 73	206 2089 106	AC CORD W/CON.E2	for E2	1	
	★ 73	206 2085 003	AC CORD W/CON.DOM	for JP	1	
	★ 74	203 6596 007	4P PH CON CORD		1	
	★ 75	445 0033 005	WIRE CLAMP BAND		2	
	★ 76	204 6307 037	11P KR-KR CON.CORD	CW911	1	
	★ 77	342 0027 000	FERRITE CORE		1	
	★ 78	415 0790 062	UL TUBE (14.3) BK	for E2,JP, for AC cord	1	
	★ 79	513 3870 021	RATING SHEET (E3)	for E3	1	*
	★ 79	513 3870 034	RATING SHEET (E2)	for E2	1	*
	★ 79	513 3906 018	RATING SHEET (J)	for JP	1	*
	★ 80	513 2303 007	VERSION LABEL		1	
	★ 81	513 1519 009	MANUFAC.DATE LABEL	for E3	1	
	★ 81	513 0985 003	INST LABEL	for E2	1	
	★ 82	513 3776 002	E3 LABEL	for E3	1	
	★ 82	513 2521 009	CE LABEL	for E2	1	
	★ 83	513 3384 009	C-UL MARK US (813)	for E3	1	
	★ 83	513 3253 004	C-TICK LABEL	for E2	1	
	★ 84	513 3159 001	FCC/CLASS B CAUTION	for E3	1	
<b>SCREWS</b>						
	51	473 7002 005	3X6 CBTS(S)-Z		15	
	52	473 8007 083	3X8 CUP SCREW		14	
	53	473 7500 044	3X8 CBTS (P)-B		1	
	54	473 7015 005	3X6 CBTS(S)-B		4	
	55	474 4300 004	2.6X4 BSS (A)		1	
	56	471 3202 010	2.6X5 CBS		2	
	57	473 7505 010	2.6X6 CBTS (P)-Z		7	
	58	471 3103 012	2X6 CBS		8	
	59	473 7505 007	2.6X8 CBTS (P)-Z		34	
	60	473 7506 022	2X6 CBTS(P)-B		4	
	61	473 8087 003	2X6 CFTS(B)-B		9	
	62	475 5122 006	2X4 HSHB		1	
	63	473 7002 021	3X8 CBTS (S)-B		5	
	64	471 1832 013	M3-SEMS SCREW(6W)		4	